

Licensing log files for PSCAD Lock-based Licensing Issues

1. Introduction

The licensing log files listed in this document can help to troubleshoot lock-based licensing issues. Or, please feel free to send in your log files to our Support Desk if you require further assistance (support@mhi.ca).

2. Licensing Log Files

The following licensing log files may be reviewed on the PSCAD machine (see Step 3 for instructions on displaying these files):

- Get Info log file
- PscadLmgr.txt file
- Lmgrd-log.txt file (if available)

In addition to the above log files, if the license is hosted on a server, the following log files on the server should also be reviewed (see Step 3 for instructions on displaying these files):

- Get Info log file
- Lmgrd-log.txt file
- PscadLmgr.txt file (if available)

3. Displaying the Licensing Log Files

To obtain the Get Info log file:

- If you have a USB lock, ensure it is securely plugged in, and that Sentinel Drivers 7.6.0 are installed on the machine for detecting the lock (download and unzip "[USBDrivers_7.6.0.zip](#)", and run "Install.bat".)
- Download "GetInfo32.zip" from the following link: <http://updater.pscad.com/utilities/GetInfo32.zip>
- Extract the "GetInfo32.exe" file, and save it to your machine.
- Launch the extracted "GetInfo32.exe" file, and when prompted whether to test shortcuts, select "No".
- The Get Info utility will display information about your system, and save the information to a file. The location of the file will be displayed in the utility, towards the bottom.

The PscadLmgr.txt file or Lmgrd-log.txt files will be located in one or more of the following locations:

- C:\Users\All Users\Manitoba HVDC Research Centre\LicenseManager
- C:\ProgramData\Manitoba HVDC Research Centre\LicenseManager
- C:\Users\YOUR-USER-ID\AppData\Local\Manitoba HVDC Research Centre\LicenseManager

Note

If the AppData folder is hidden, set hidden folders to display as shown:

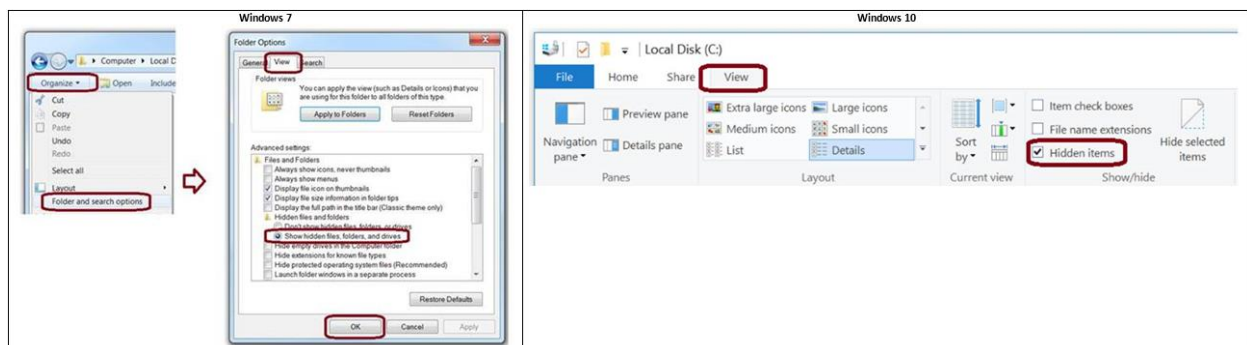

Copyright © 2020 Manitoba Hydro International Ltd. All Rights Reserved.